



zd | zutaledesign

ARCHITECTURAL LIGHTING DESIGN / WWW.ZUTALEDESIGN.COM



Image: Hamad International Airport / Doha, Qatar

Company Profile

Zutalé Design is a full service Architectural Lighting Design firm with a diverse background of projects and experience spanning from commercial to transportation, entertainment to hospitality and towers to higher education. Our design and consulting services for Architectural Lighting and Lighting Controls Systems for interior and exterior projects of all shapes and sizes are available to clients throughout the U.S. and international markets.

With a focus on Architectural Lighting Design and backgrounds that includes Interior Design, Architecture, Construction, Graphic Design and Web Development we bring vision, technical analysis and teamwork to the forefront of our work as our commitment to design quality and distinction.

The process of working closely with our clients, architects, designers and construction teams regardless of how near or far the location in order to meet the complex needs of any scale project is one that we thoroughly enjoy. It is through this challenging and interactive design process, that we are able to consistently provide quality service and successful projects for our clients and design team members. We invite you to become a part of this team and look forward to the opportunity to collaborate.

Our team strives to go above and beyond what might be considered part of the typical design process. We welcome the opportunity to work on unique projects and are ready to discuss any creative design challenges that you may have!



Image: Zifeng Tower / Nanjing, China



Image: Zifeng Tower / Nanjing, China

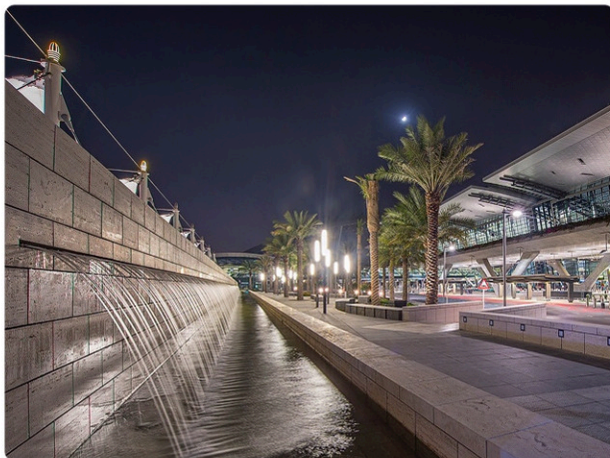

Hamad International Airport

Hellmuth Obata & Kassabaum / San Francisco
Exterior, Site and Roadway Lighting Design
Doha, Qatar

Project Role
Senior Lighting Designer
Project Manager

Project Services
Schematic Design
Design Development
Construction Documents
Construction Administration

Project Duration
2004 - 2012

* Completed with PHA Lighting Design

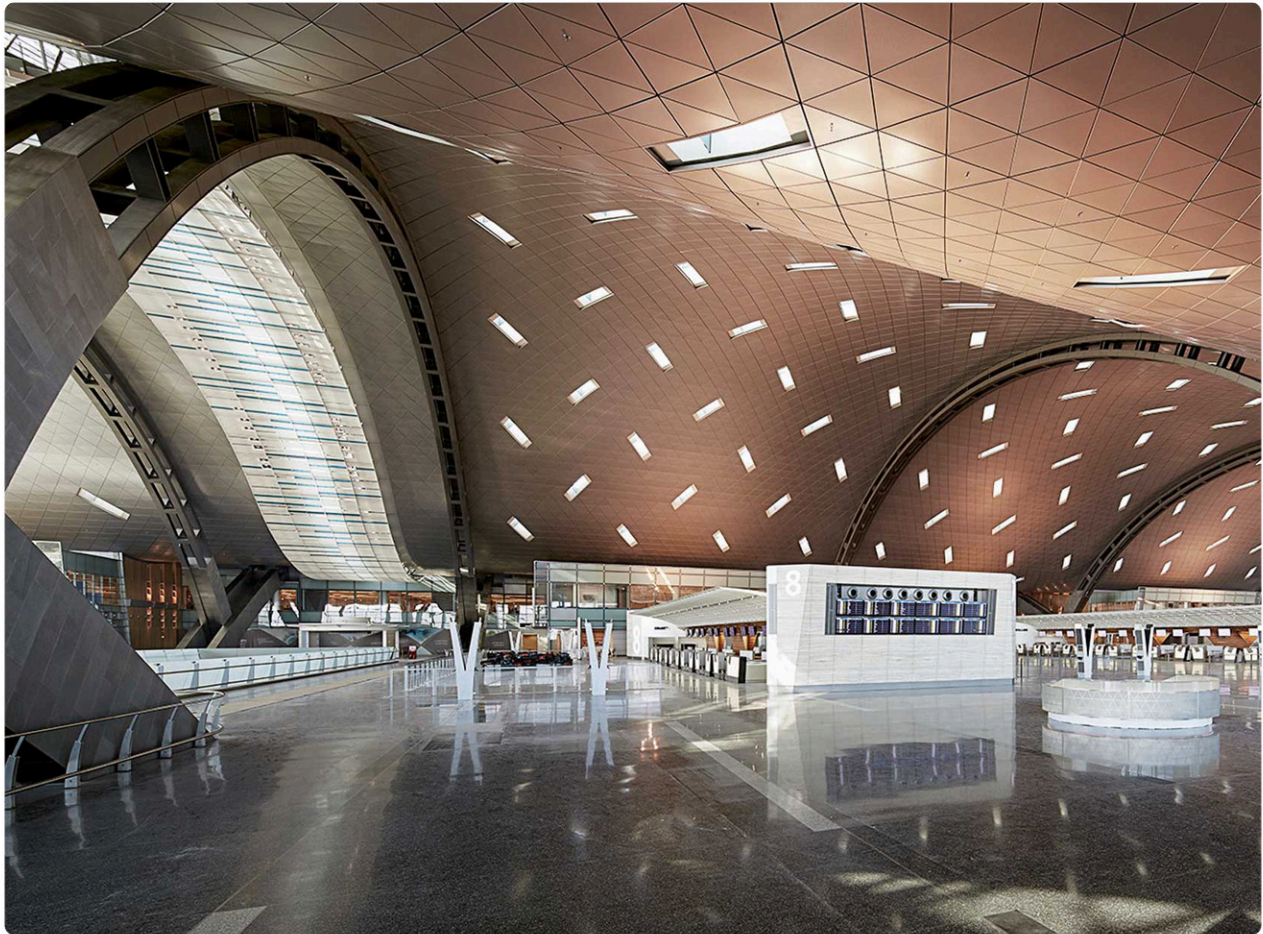

Hamad International Airport

Hellmuth Obata & Kassabaum / San Francisco
Interior Lighting Design - Main Terminal and Concourses
Doha, Qatar

Project Role
Senior Lighting Designer
Project Manager

Project Services
Schematic Design
Design Development
Construction Documents
Construction Administration

Project Duration
2004 - 2012

* Completed with PHA Lighting Design



Hamad International Airport

Hellmuth Obata & Kassabaum / San Francisco
Interior Lighting Design - Airport Hotel and Spa
Doha, Qatar

Project Role
Senior Lighting Designer
Project Manager

Project Services
Schematic Design
Design Development
Construction Documents
Construction Administration

Project Duration
2004 - 2012

* Completed with PHA Lighting Design

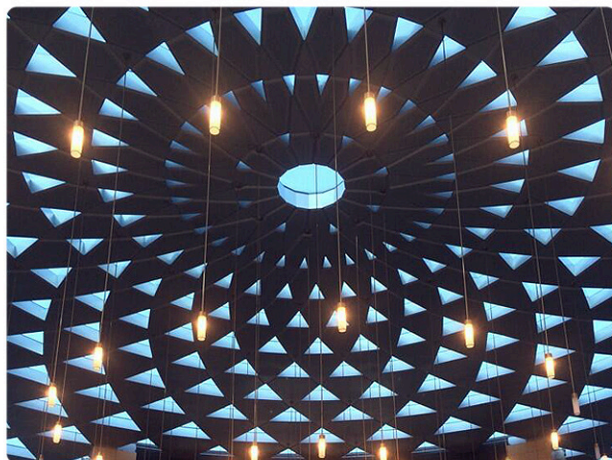

Hamad International Airport

Hellmuth Obata & Kassabaum / San Francisco
Interior, Exterior and Plaza Lighting Design - Airport Mosque
Doha, Qatar

Project Role
Senior Lighting Designer
Project Manager

Project Services
Schematic Design
Design Development
Construction Documents
Construction Administration

Project Duration
2004 - 2012

* Completed with PHA Lighting Design



University of Texas Robert B. Rowling Hall

Ennead Architects / New York and Jacobs / Dallas
Interior, Exterior and Site Lighting Design
Austin, Texas

Project Role
Senior Lighting Designer

Project Services
Schematic Design
Design Development
Construction Documents

Project Duration
2013-2015

* Completed with Pictural Lighting Design

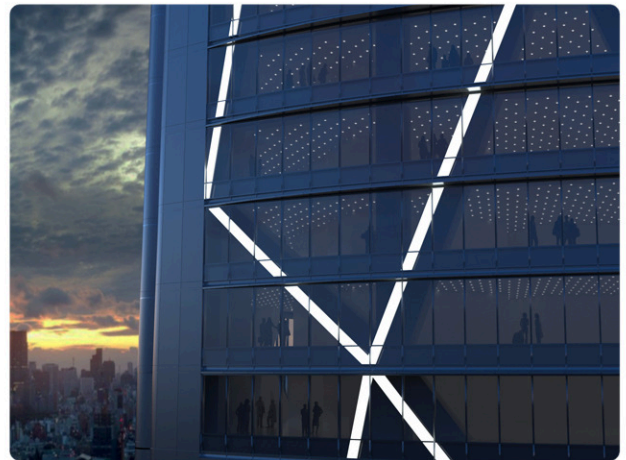
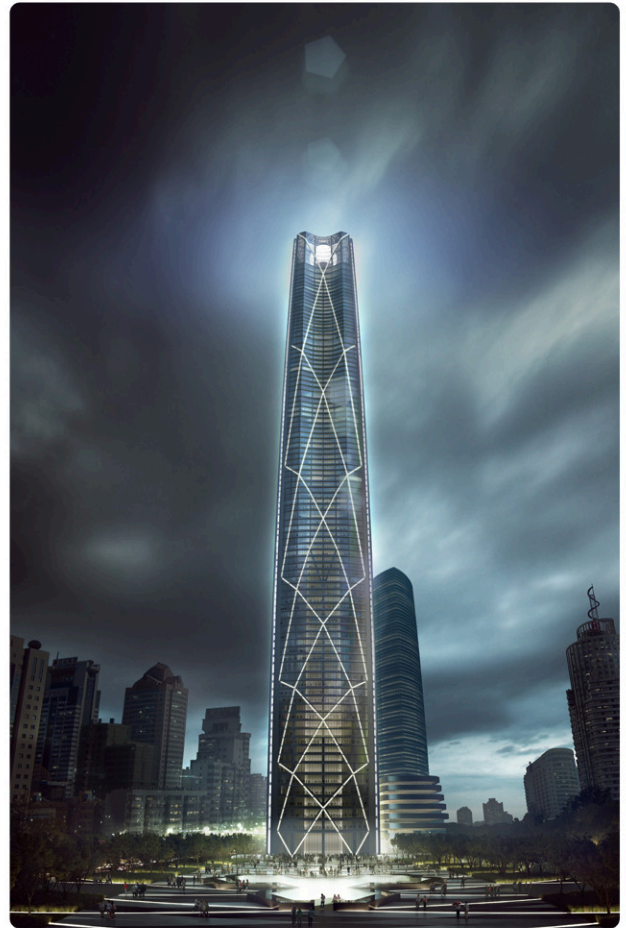

Eye of Spring Tower

Skidmore Owings and Merrill / Chicago
Exterior Facade and Observatory Lighting Design
Kunming, China

Project Role
Lead Lighting Designer
Project Manager

Project Services
Schematic Design
Design Development

Project Duration
2013-2015

* Completed with Pictural Lighting Design

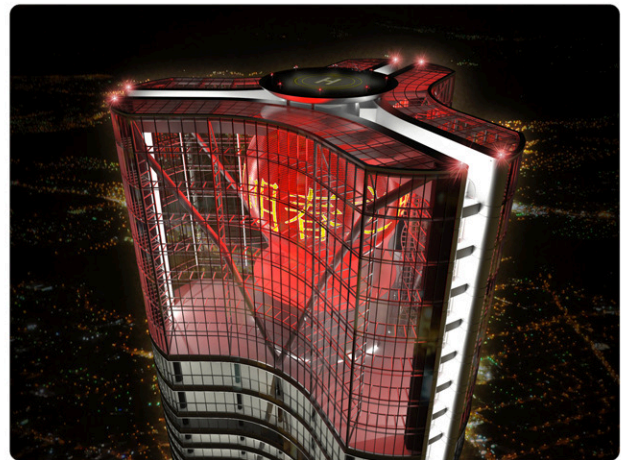
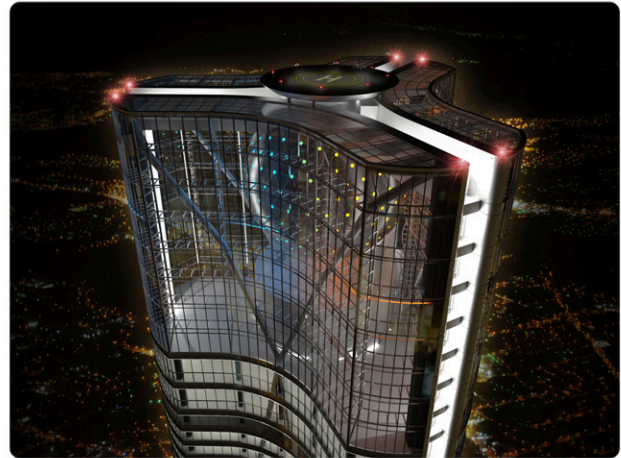
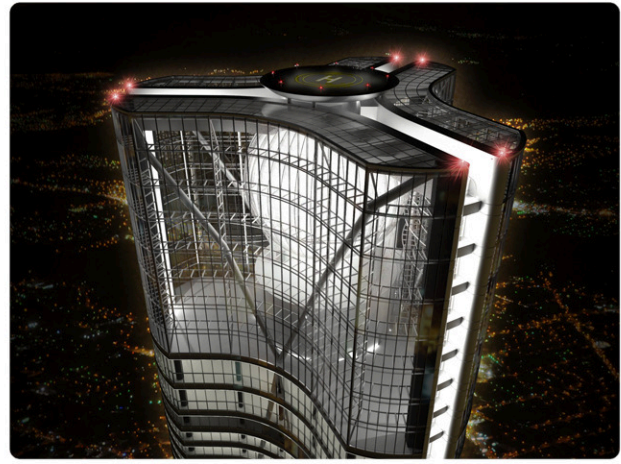
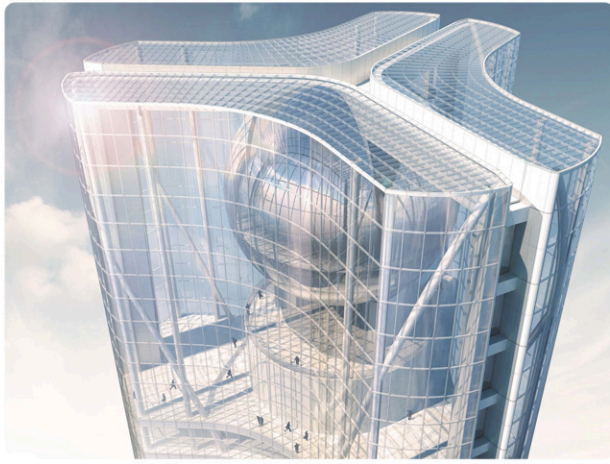

Eye of Spring Tower

Skidmore Owings and Merrill / Chicago
Exterior Facade and Observatory Lighting Design
Kunming, China

Project Role
Lead Lighting Designer
Project Manager

Project Services
Schematic Design
Design Development

Project Duration
2013-2015

* Completed with Pivotal Lighting Design



Marriott Marquis

TVS Design / Atlanta
Interior Lighting Design
Atlanta, Georgia

Project Role
Senior Lighting Designer

Project Services
Schematic Design
Design Development
Construction Documents
Construction Administration

Project Duration
2005-2008

* Completed with PHA Lighting Design



Marriott Marquis

TVS Design / Atlanta
Interior Lighting Design
Atlanta, Georgia

Project Role
Senior Lighting Designer

Project Services
Schematic Design
Design Development
Construction Documents
Construction Administration

Project Duration
2005-2008

* Completed with PHA Lighting Design

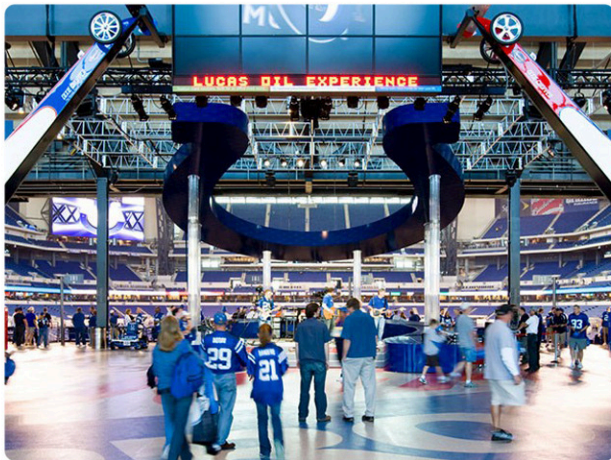

Lucas Oil Stadium

HKS Architects / Dallas
Interior and Exterior Lighting Design
Indianapolis, Indiana

Project Role
Senior Lighting Designer
Project Manager

Project Services
Schematic Design
Design Development
Construction Documents
Construction Administration

Project Duration
2005-2008

* Completed with PHA Lighting Design



The Peaks Resort and Golden Door Spa

Skidmore Owings and Merrill / Chicago
Interior and Exterior Lighting Design
Mountain Village, Colorado

Project Role
Senior Lighting Designer
Project Manager

Project Services
Schematic Design
Design Development
Construction Documents
Construction Administration

Project Duration
2005-2007

* Completed with PHA Lighting Design



The Peaks Resort and Golden Door Spa

Skidmore Owings and Merrill / Chicago
Interior and Exterior Lighting Design
Mountain Village, Colorado

Project Role
Senior Lighting Designer
Project Manager

Project Services
Schematic Design
Design Development
Construction Documents
Construction Administration

Project Duration
2005-2007

* Completed with PHA Lighting Design



The Peaks Resort and Golden Door Spa

Skidmore Owings and Merrill / Chicago
Interior and Exterior Lighting Design
Mountain Village, Colorado

Project Role
Senior Lighting Designer
Project Manager

Project Services
Schematic Design
Design Development
Construction Documents
Construction Administration

Project Duration
2005-2007

* Completed with PHA Lighting Design

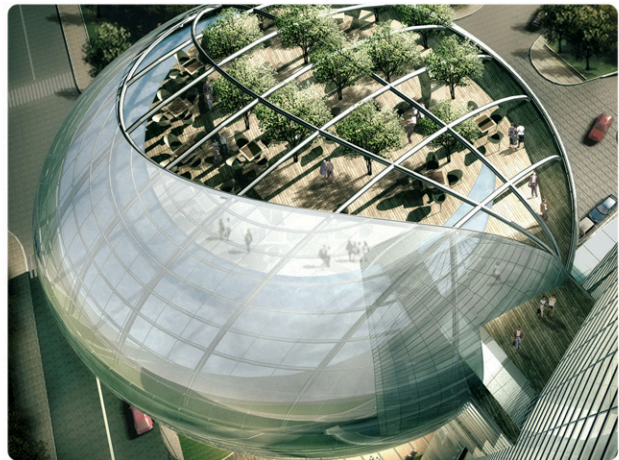

Pearl River Tower

Skidmore Owings and Merrill / Chicago
Interior Amenity Levels Lighting Design
Guangzhou, China

Project Role
Lead Lighting Designer
Project Manager

Project Services
Schematic Design
Design Development

Project Duration
2009

* Completed with PHA Lighting Design



Metropolis Investment Holdings

Skidmore Owings and Merrill / Chicago
Interior Lighting Design
Chicago, Illinois

Project Role
Lead Lighting Designer
Project Manager

Project Services
Schematic Design
Design Development
Construction Documents
Construction Administration

Project Duration
2009

* Completed with PHA Lighting Design



Zifeng Tower

Skidmore Owings and Merrill / Chicago
Interior Lobby and Exterior Facade Lighting Design
Nanjing, China

Project Role
Senior Lighting Designer

Project Services
Schematic Design
Design Development

Project Duration
2005-2007

* Completed with PHA Lighting Design



ture degree and a Bachelor of Arts in Architectural Design from the



JW Marriott

DiLeonardo / Providence and Lucien Lagrange / Chicago
Interior Lighting Design
Chicago, Illinois

Project Role
Senior Lighting Designer
Project Manager

Project Services
Schematic Design
Design Development
Construction Documents
Construction Administration

Project Duration
2007-2010

* Completed with PHA Lighting Design



Erin Flaum

Partner . Director of Architectural Lighting Design

Erin Flaum is a Partner and Design Director of Architectural Lighting Design at Zutale Design. Ms. Flaum specializes in the creative design and development of Architectural Lighting and Lighting Controls Systems. Her background in Interior Design provided the foundation of her interest to uniquely shape architectural environments through the use of light. Her skills allow her to quickly understand and visualize design concepts while offering adept attention to detail and the ability to work as an integral part of the design team. Beyond creating comfortably inspiring spaces, Ms. Flaum advocates her role as a designer from conceptualization through construction so as to ensure the integrity of a project's design.

Ms. Flaum's career in Architectural Lighting Design has been uniquely focused on complex projects of every scale with a diverse array of architects, designers, clients, construction teams and sites located around the world. From San Francisco to Toronto to Qatar, Ms. Flaum is at home on the ground working in tandem with teams in the local environment as well as coordinating from the home office. Her role goes beyond designer and manager as she delves into every phase of the project from Design to Documentation and Construction. It is her goal to ensure the integrity of the project's design and to see its success both functionally and aesthetically.

Throughout Ms. Flaum's career, she has been involved in many long-term projects allowing her to form a greater understanding of clients' needs and design goals. Her design and management skills have helped her create enduring relationships with many clients and reinforced her strong standing within the design and construction communities. Ms. Flaum continues to employ her design and management skills and strives to build client relationships using the same foundation.



Image: Zifeng Tower under construction (Nanjing, China)



Christopher Ciraulo

Partner . Technical Design Director

Christopher Ciraulo is a Partner and Technical Design Director for Architectural Lighting Design at Zutalé Design. Mr. Ciraulo specializes in architectural design and technical coordination and brought with him over ten years of design experience from Architectural and Interior Design to Graphic Design and Web Development. His wide range of technical abilities and dedication to his projects and clients have created a solid reputation with architects, designers, consultants, clients and contractors with regards to both domestic and international projects.

Prior to creating Zutalé Design, Mr. Ciraulo was an architectural site representative at Skidmore Owings and Merrill's Chicago Office. Mr. Ciraulo joined the SOM Chicago office in 2005 as an Interior Design Assistant with the Interior Design Studio after graduating from the Massachusetts Institute of Technology's School Of Architecture, with a Master of Architecture degree. After seven years with SOM, including eighteen months spent on-site at the UNC Bell Tower Development in Chapel Hill, North Carolina, he returned to Chicago and joined Studio Gang Architects in 2013. There, he worked with the team on several projects, including the Campus North Residence Hall at the University of Chicago and the 160 Folsom Tower in San Francisco.

Mr. Ciraulo's ability to focus on and visualize the complex architectural detailing required for many of the design concepts being developed at SOM during his time there led him to work with several Interior and Architecture studios on projects ranging from the Peaks Resort and Spa in Telluride, Colorado; the Nanjing Greenland Financial Center in Nanjing, China; the Burj Khalifa in Dubai, UAE; and the UNC Bell Tower Development project in Chapel Hill, North Carolina. He became the technical coordinator on several of these projects and was able to conceptualize design ideas during the Schematic Design phase, present them to the client and eventually give them three-dimensional form within the Construction Documentation and Administration phases.



Image: The Peaks Resort and Golden Door Spa Exterior View (Colorado)

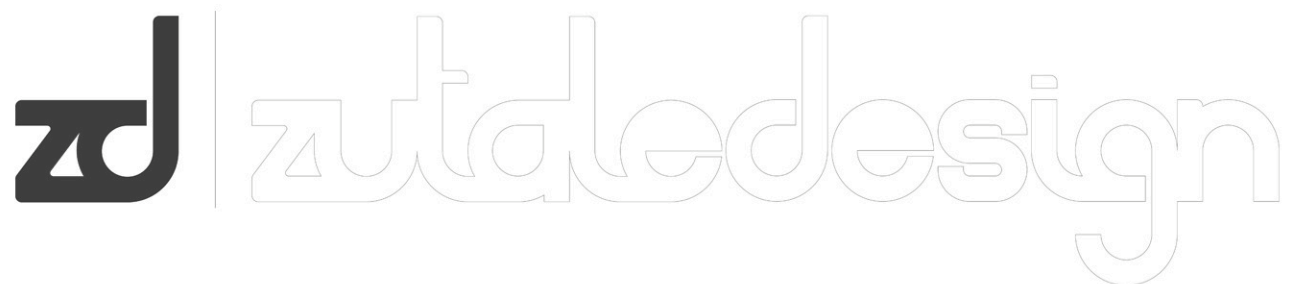

WWW.ZUTALEDESIGN.COM / INFO@ZUTALEDESIGN.COM / 773.609.3130